



DONRACKS
one stop storage solutions

A COMPLETE INDUSTRIAL & WAREHOUSING
STORAGE SOLUTIONS

PRODUCT CATALOGUE

www.donracks.com

DONRACK'S

one stop storage solutions



About Us

DONRACKS of Warehousing and Industrial Storage Systems are manufactured by TMTE METAL TECH Pvt Ltd. with experience of over three decades in providing storage solutions to customers across diverse industries such as 3PL, Cold Chain, FMCG Warehousing, Automotive, E-commerce, Retail, Pharmaceutical etc. Our products add value to our customers by enabling them to optimize their storage space through our modular storage equipments.

DESIGN

Our expert design team provides solutions that maximize your storage capacity. Our Layout design are based upon

- Maximum Utilization of available space
- Minimizing Man & Material Movement
- Reduction in Throughput time
- Increasing Storage Capacity

MANUFACTURING

Our state of the Art Manufacturing Facility of about 75000 sq.ft. is located at Ambattur, Chennai.

Salient features of our manufacturing process are

- Steel procurement from JSW / TATA
- Pretreatment in 7 tank zinc phosphating method for increased product life
- TQM to ensure highest customer satisfaction

EXECUTIONS

Our Project Executions are strictly monitored by an integrated team of experts. Our team would complete the installation of our products by using the most efficient and effective methods to meet customer deadlines. Quality Audit, Safety Audit, Timeline Commitment & Customer Feedback are integral part of our project execution process.



CONSULTING | DESIGN | MANUFACTURE | SUPPLY | INSTALLATION

PRODUCT RANGE



PALLET RACKS



DRIVE-IN RACKS



VNA RACKS



DOUBLE DEEP RACKS



SHELVING RACKS



MULTI-TIER SHELVING RACKS



SLOTTED ANGLE RACKS



CANTILEVER RACKS



FIFO RACKS



MEZZANINE FLOOR



PLASTIC PALLET



PLASTIC BIN

PALLET RACKS

Selective Pallet Racking (SPR) is probably the most widely used type of pallet racking, and offers free access to every pallet held. It can be built to match the lift height of various material handling equipments. It consists of Upright end frames and pairs of horizontal beams on which the pallets are located, and beam heights are adjustable to suit the height of the pallet loads being stored. SPR is flexible, versatile storage system, which gives excellent stock access.

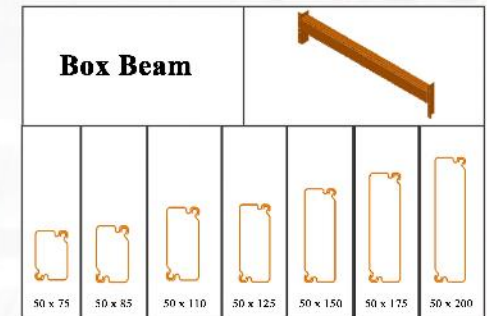
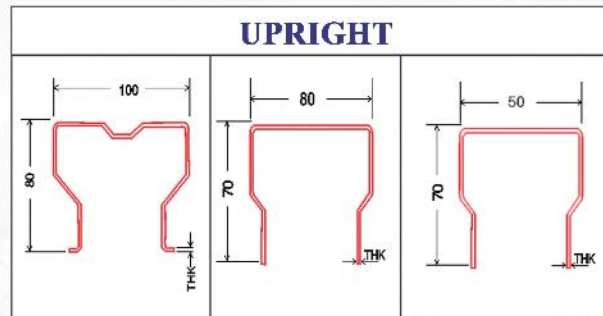

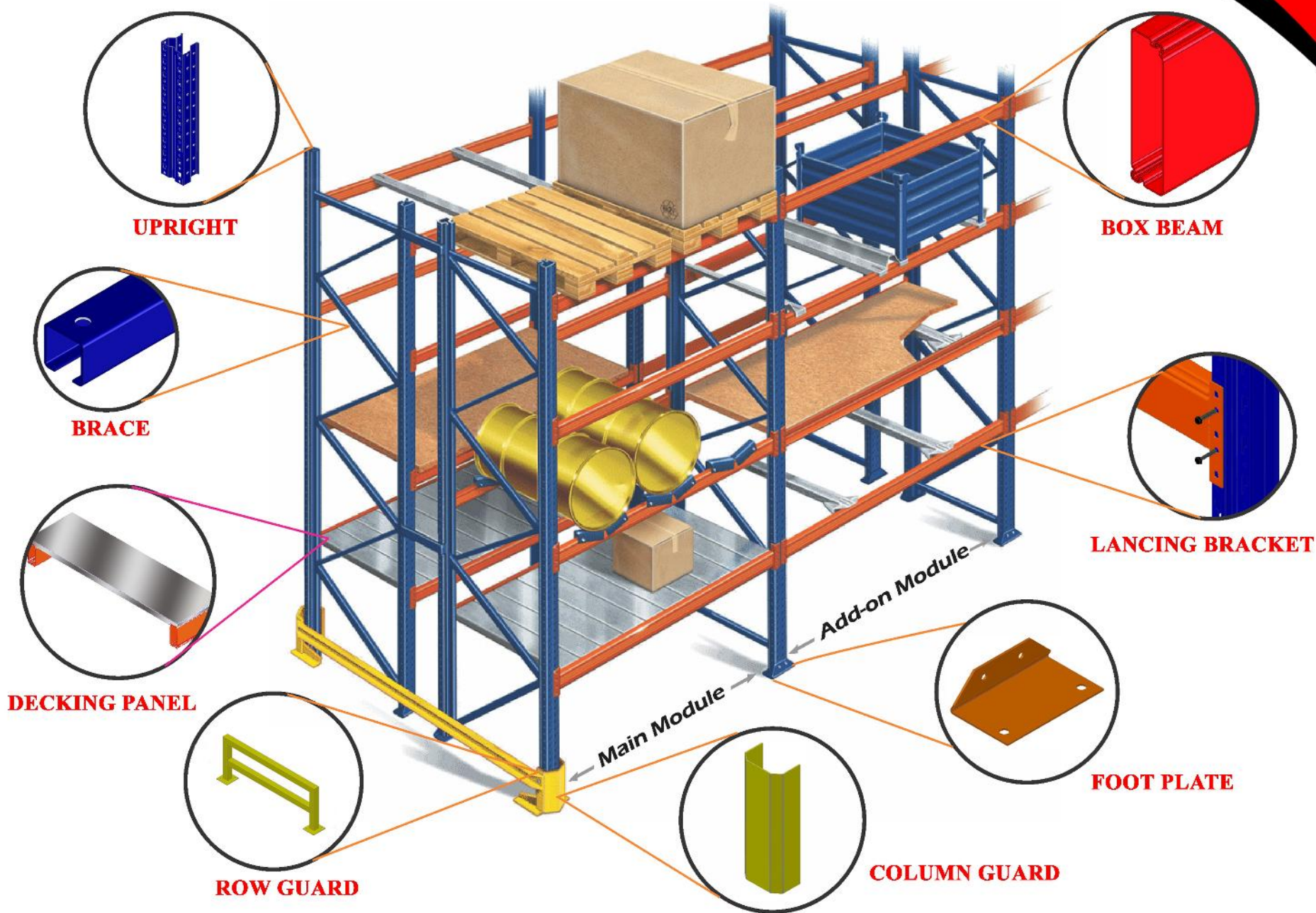

DRIVE-IN RACKS

For cost-effective, high-density storage Drive-in / Drive-through racks is often the choice. Requiring fewer aisles, and providing better cube utilization than selective racks, Drive-in / Drive-through rack allow you to store upto 75% more pallets than with selective racking. Forklifts drive directly into the rack allow storage of two or more pallets deep. A drive-in rack is used to address repetitive products and serves to take advantage of cubic space available for storage, when such unit loads do not lend themselves to block stacking. A Drive-in rack is closed at one end, allowing for last-in, first-out (LIFO) storage. A Drive-through rack is open at both ends, allowing first in first out (FIFO) storage.



Comparison of Drive-in rack and Pallet rack systems

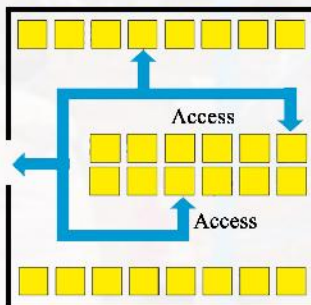

■ Pallet rack system

Access occupied ratio	56.25%
Number of storable pallets	84

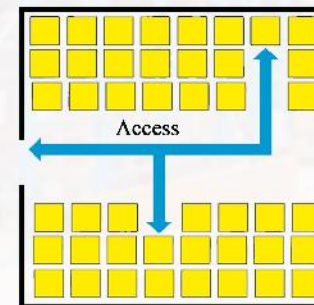

■ Drive-in rack

Access occupied ratio	26%
Number of storable pallets	144



Benefits of Drive-in Pallet Rack

- The same entry and exit point on each side of storage bay is used to access loads, creating last-in / first-out storage.
- It is the highest density pallet racking system available.
- Available surface and height space is utilized by Drive-in pallet rack than any other system.
- Load flexibility for both weight and volume

VNA RACKS

VNA racks may be set out in much narrower aisles than those required by reach truck operation. High-rack stacker trucks, equipped with rotating or sliding pallet handling mechanisms, do not need to turn in an aisle to access pallet locations and in very narrow aisle racking system it can typically operate in aisles of 1.8 metres or less. They can also lift higher than reach trucks, and these two factors increase the space utilization. VNA racks are common in warehouse with large pallet reserve storage areas.

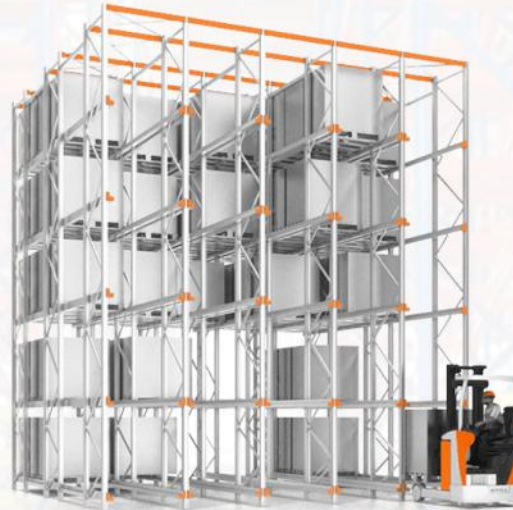

If some loss of totally free access to stock can be accepted, although not nearly as severe as in block, Drive-in or push back storage, space utilization can be improved using Double-deep racking. This supports pallets on pairs of beams as in SPR, but improves space utilization by eliminating alternate access aisles and using a double-reach fork-lift truck, which can access not just one but two pallets deep into the racking. Pallet position utilization in Double-deep racks is typically of the order of 85 percent, depending on the precise application.

DOUBLE DEEP RACKS



SHELVING RACKS



Shelving Racks are generally made from standard modular components that allow installations of different heights, vertical shelf spacing and shelf depths. the typical standard span width is 1 metre, but long span shelving is also available that facilitates the holding of longer items of stock. subdividers can be used to provide even smaller locations where this is appropriate for the inventory being held.

Shelving Racks can be accessed in various ways - from ground-floor level, from mezzanine levels or from fixed-path or free-path lifting equipment such as narrow-aisle picking trucks and picking cranes. A variant on this concept is cantilever shelving, which is supported from the back and sides, and gives completely clear access from the front and hence flexibility for holding items of different lengths. This is suitable for light and medium duty loads. Shelving units can be assembled rapidly and adapted to change and expansion. Each shelf can be adjusted independently used efficiently, this allows the storage space to be used to the maximum.

Multi-tier Shelving Racks is mainly used for storage and order picking of non-palletised goods, bins, cartons or other storage units containing small parts and components for bulk storage.

Multi-tier Shelving Racks helps to increase storage efficiency by making full use of the available vertical space and storage volume. A good utilisation of the warehouse height leads to reduced order processing times as additional tiers allow to set up further storage and order picking installations, thus creating extra room for manufacturing, assembly or office areas. Stairs and / or lifts connect the walkways / aisles on different tiers.

MULTI - TIER SHELVING RACKS

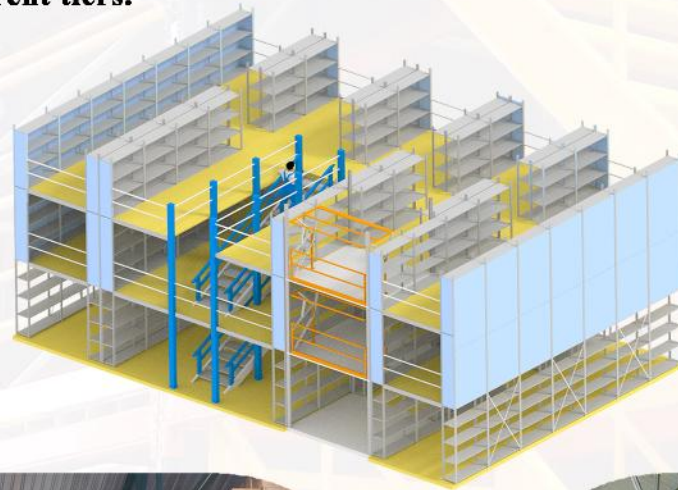

SLOTTED ANGLE RACKS



Sway Arrestor

Only DONRACKS slotted angle racks have Sway Arrestor which provides increased stability.

Corner Support

It Provides increased fixity between the self & the angle and also aids in prevention of shaking loading.



CANTILEVER RACKS



Cantilever racks are a superior storage solution in many situations. They are especially useful for storing long, bulky or oddly-shaped loads. Compared to standard pallet racks, cantilever racks are easier to use with no front column in the way, cantilever racks are faster to load and unload lowering handling time and costs. It is also more flexible and compact storage solution. Any load or storage slot is immediately accessible making it a very highly selective storage system. With both reduced handling times and increased space utilization helps make cantilever racks more cost-efficient. Additionally, cantilever racks become more economical as load length increases, while standard pallet racks increase in costs. These types of racks can store nearly any type of loads.

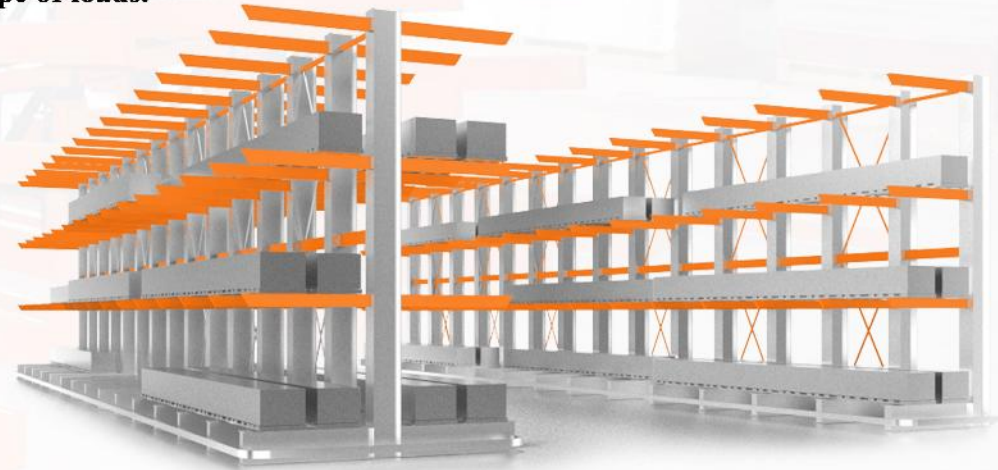

FIFO RACKS

FIFO - First In First Out Racks are made of robust racks structure with inclined shelves equipped with roller channels or flow rails. These types of racks are widely used for bins storage in assembly lines. In these type of racks, loads (bins) are stored on roller channels positioned inclined on the racks. These loads travel from the loading end to the unloading end. The first load entered is always the first load taken out. Constant stock rotation is ensured in FIFO racks.

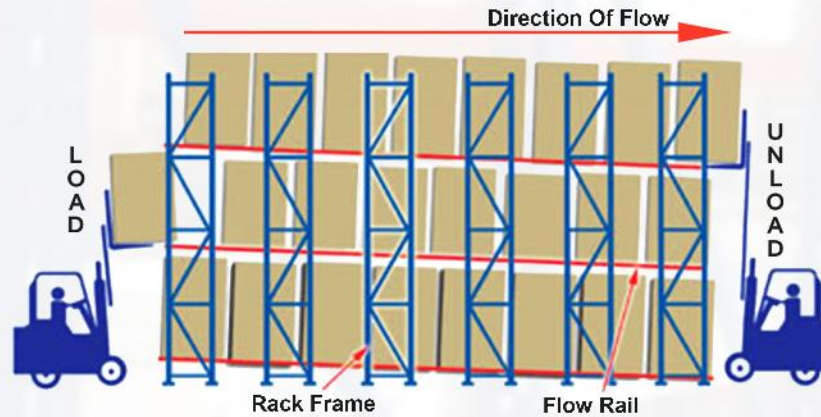

A Mezzanine floor is essentially a raised platform that is supported by steel columns and is totally independent of the host building. It allows you to create additional floor space from wasted air space above existing work and storage areas and can be used to create extra office, storage can be added to the existing frame work of the floor.

Mezzanine floors are easy to install, have simple nut and bolt assembly, and can also be easily expanded, modified or moved, as per the requirements of our clients.

MEZZANINE FLOOR



SITE PICTURES



SITE PICTURES



OUR VALUABLE CUSTOMERS PAN INDIA



OUR VALUABLE CUSTOMERS PAN INDIA



India's No. 1 Dealer
VASANTH & CO



TIMKEN

INGRAM MICRO



ROYALOAK
INTERNATIONAL FURNITURE
UNBEATABLE PRICE

infinitiretail Ltd
The future of retailing



HYUNDAI
WIA

BorgWarner

ColdEX
Piping hot cold chain technology

flex

hyperpure
by **zomato**



Polyhose
Providing Flexible Solutions Globally

MODINE

BLUE DART

SPEAR
AN FM LOGISTIC COMPANY

TENNECO

SHRIRAM
Commercial Vehicle Finance
GETS YOU GOING

asianpaints

Information Required To Serve You Better

- Warehouse / Industrial Area Layout
- Clear Height Available
- Load Unit Type - Carton / Pallet / Bins / Others
- Load Unit Size - L x B x H (mm)
- Load Unit Weight / Load Level Capacity
- Material Handling Equipment Used (if any) Forklift / Stacker / Reach Truck / Others

TMTE METAL TECH PRIVATE LTD

CORPORATE OFFICE AND FACTORY

25-A/2, North Phase, Aavin Dairy Road

SIDCO Industrial Estate, Ambattur, Chennai-98, Tamilnadu, India

☎ 044-26244650, +(91) - 9380241286

OUR PRESENCE

**CHENNAI • COIMBATORE • TRICHY • KOCHI • BANGALORE •
HYDERABAD • VIJAYAWADA • MUMBAI • PUNE • DELHI**

Email : sales@donracks.com / hdrsupport@donracks.com

www.donracks.com